



ADDENDUM #1

August 8, 2013

Re: HACC, Central PA's Community College
Harrisburg Campus, SMHEP Nursing Lab Renovations
Solicitation # 14-02

From: Eastern PCM, LLC
Construction Manager – HACC
645 N. 12th Street, Suite 200
Lemoyne, PA 17043

To: All Planholders

This Addendum is hereby made part of the Plans and Project Manual dated July 11, 2013, for the above referenced project. The provisions of this Addendum are intended to supplement the provisions of the Plans and Project Manual and/or supersede them where contradictory thereto.

This Addendum contains changes to the requirements of the Plans and Project Manual. Such changes shall be incorporated into the Plans and Project Manual and shall apply to work with the same meaning and force as if they had been included in the original Plans and Project Manual. Where this Addendum modifies a portion of a paragraph or phrase of the Project Manual, the remaining unmodified portion of the paragraph or phrase shall remain in force.

The conditions and terms of the Plans and Project Manual shall govern work described in this Addendum. Whenever the conditions of work, or the quality or quantity of materials or workmanship are not fully described in this Addendum, the conditions of work etc. included in the Plans and Project Manual for similar items of work shall apply to the work described in this Addendum. If no similar items of work are included in the Plans and Project Manual, the quality of material and workmanship shall be subject to the written acceptance of the Architect.

1.1 PRE-BID MEETING MINUTES

Meeting minutes from the Pre-Bid Meeting held on August 1, 2013 are attached and are a part of this Addendum. In the event of a conflict between the information contained in the Pre-Bid Meeting Notes and the Drawings, Specifications and responses to questions contained in this Addendum, the latter shall take precedence.

1.2 CLARIFICATIONS

- A. A second site visit will take place on Friday, August 9, 2013. All Contractors interested in attending, shall meet in the lobby located inside of the southeast entrance at 10:00AM.
- B. The location of the opaque window film is shown in Detail C5 on Sheet A001.
- C. The existing fire alarm system is a Siemens system.
- D. Remove all references to the project sign. No sign will be required.

1.3 CHANGES TO THE SPECIFICATIONS

- A. Cover:
 - a. **REPLACE** this cover in its entirety.
- B. Section 00150 – Information for Bidders:
 - a. **REVISE** 5.A.iii to read “iii. Substantial Completion: January 13, 2014”

1.4 ATTACHMENTS

- A. Meeting Minutes from the Pre-Bid Meeting, dated August 1, 2013
- B. Project Manual Cover

END OF ADDENDUM



Please sign and return this page, via fax, to Eastern PCM, LLC at (717) 233-1666 indicating receipt of this Addendum.

**SMHEP Nursing Lab Renovations
Solicitation # 14-02**

Addendum # 1 has been received.

Company: _____
Print Company Name

Received By: _____
Print Name Signature

Date: _____

Please check one:

- _____ We are bidding as a prime contractor
- _____ We are not bidding
- _____ We are a sub-contractor

**Harrisburg Area Community College
SMHEP Nursing Lab Renovations
Harrisburg Campus**

Pre-Bid Meeting

August 1, 2013
8:00 am

Meeting Minutes

Attendees

Joe Wojtysiak – HACC	John Glass – Hogg Construction
Garry Crider – HACC	Lowell Hess – Hogg Construction
Troy Clark – Titan Construction	Brian Murphy – Mid-State
Sid Kohr – Dorgan and Zuck	Justin Kovaleski – Eastern PCM, LLC (EPCM)
Bob Royer – K.S. Heagy Contractor	Sarah Centini - EPCM
Sam Sterkenberg – S.P. Construction and Design	

1.0 Mr. Kovaleski welcomed all attendees on behalf of HACC.

1.1 Introduction of Team

- | | |
|----------------------------|--|
| a) Owner | HACC, Central Pennsylvania’s Community College |
| | Joe Wojtysiak Facilities Director |
| | Garry Crider Procurement Services Director |
| b) Architect | FP+A, Inc. |
| | Joshua Millman Principal |
| | Kevin Stick Project Manager |
| c) Construction
Manager | Eastern PCM, LLC |
| | Greg Lamay Project Manager |
| | Sarah Centini Project Engineer |

1.2 Bid Documents in electronic format are available on CD directly from Eastern PCM for a fee of \$25.00.

1.3 EPCM reviewed the bid form and bid documents found in Division 0 of the Project Manual. Bidders were instructed that the following forms must be submitted with the bid: completed Bid Form, Non-Collusion Affidavit, MBE/WBE Utilization Form and Bid Security.

1.4 Schedule

Bid Date	Thursday, August 22, 2013 at 2:00 PM EST at Three Penn Center, 349 Wiconisco Street, Room 223, Harrisburg, PA
Contract Award	October 2, 2013 subject to HACC Board of Trustees approval
Notice to Proceed	October 9, 2013 subject to execution of each contract
Substantial Completion	January 13, 2014

- 1.5 All questions are to be directed to Greg Lamay in the office of the Construction Manager in writing via fax or e-mail: Fax (717) 233-1666, E-mail: epcm@easternpcm.com. The last day for questions is August 14, 2013.
- 1.6 Addenda will be emailed or sent via Fed-Ex, depending on the size of the document. Addendum #1 will be issued approximately one week after the Pre-Bid meeting. Additional Addenda will be issued as required.
- 1.7 This project is subject to PA Prevailing Wage Rates as described in Specification Section 00820.
- 1.8 The general construction permit will be paid for and obtained by the Owner. Trade specific permits are to be obtained and paid for by applicable contractors in accordance with jurisdictional requirements.

1.9 Project Overview

The work will be performed under a Single Prime Contract and consists of the construction of an “In Situ Lab”, an observation/computer room, and a new “Sim-Man Room”. The work will include selective demolition, construction of drywall partitions, hollow metal doors, clerestory aluminum windows, painting, dust protection, and associated mechanical, electrical and plumbing systems to support the renovations.

Working hours will be from 10:00PM – 7:00AM.

- 1.10 Contractor parking and staging will be discussed at the Pre-Construction Meeting, but will be accommodated in the parking lot adjacent to the SMHEP building.
- 1.11 Dust must be completely contained in the areas of construction.
- 1.12 Staff and student access to lab areas, including storage rooms, must be maintained at all times during construction.
- 1.13 Daily cleanup of the job site will be the responsibility of the Contractor. The active campus is expected to stay clean and clear of any construction equipment, supplies and/or debris at all times.
- 1.14 Contractor must provide protection of existing installations.
- 1.15 Contractors may access the nursing lab via the south stair and/or the elevator. Contractor must provide protective pads for the interior of the elevator if it is going to be utilized. See attached “Exhibit A”.
- 1.16 Contractor’s dumpsters will be located in the back of the SMHEP building adjacent to HACC’s dumpsters.
- 1.17 All vehicles, equipment and materials must be kept off of the grass/landscaped areas on campus.
- 1.18 A tour was conducted after the meeting.

- 1.19 Anyone wishing to visit the site throughout the bid period can contact Sarah Centini to schedule a visit.
-

Respectfully Submitted,
Sarah E. Centini, Eastern PCM, LLC

The above summations are the interpretation of the author as to the items discussed and the decisions reached. Corrections or additions to these minutes are to be made in writing and sent to the attention of the Author no later than 5 days after receipt; otherwise, these minutes will stand as written.

cc: All Attendees

EXHIBIT 'A'

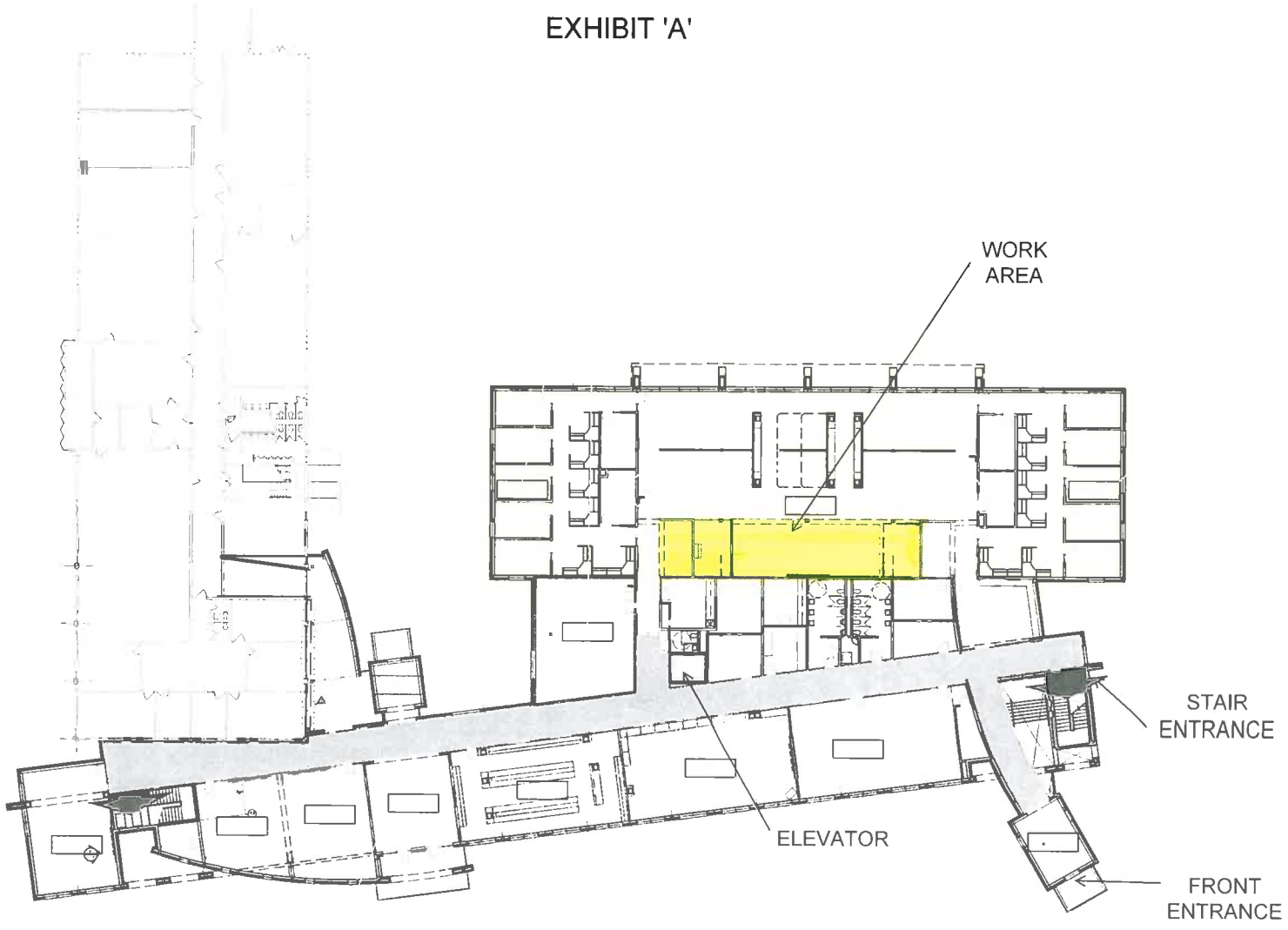



Select Medical Health Education Pavilion Nursing Lab Renovations

Solicitation #14-02

PROJECT MANUAL

July 25, 2013

Construction Manager



645 N. 12th Street, Suite 200
Lemoyne, PA 17043
Phone: (717) 233-3816
Fax: (717) 233-1666

Architect



4201 East Park Circle
Harrisburg, PA 17111
Phone: (717) 221-9700
Fax: (717) 221-1185